

Anexa- Dimensiuni orientative

Sala E401

E 401 Rolete - opacitate 60%

1. $0,65 \times 1,40 \text{ m} = 0,91 \text{ mp}$
2. $1,7 \times 1,40 = 2,38 \text{ mp}$
3. $0,60 \times 1,70 = 1,02 \text{ mp}$

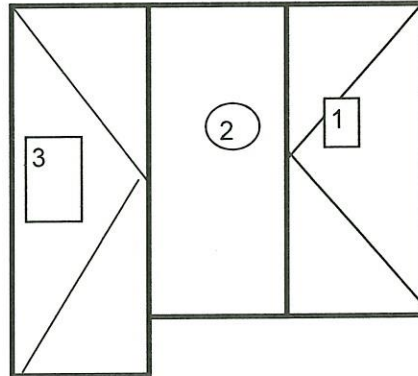

Total: 4,31 mp

Dimensiuni orientative - Rolete

Sala E100

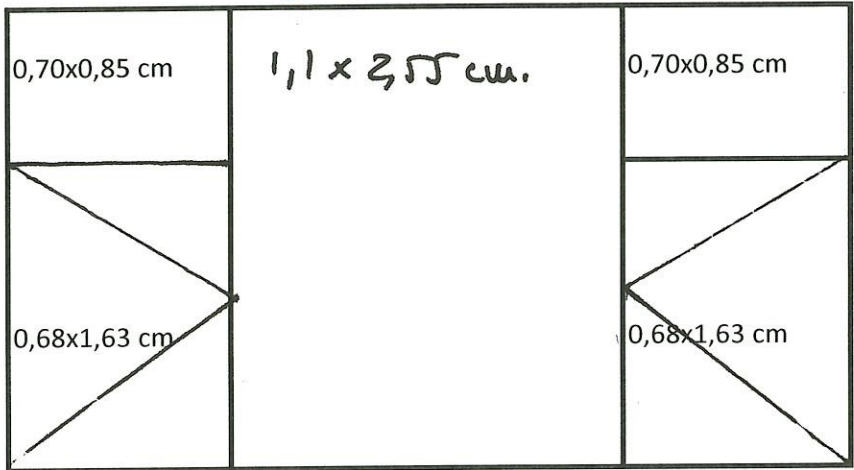

Suprafate estimata. 6,20 mp

Sala E 103

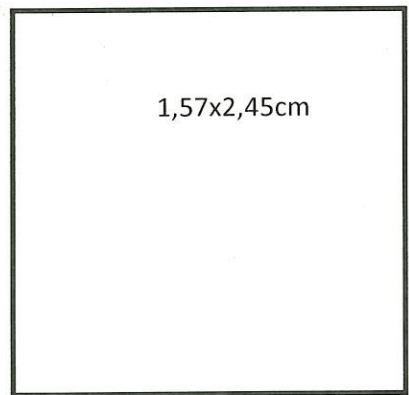
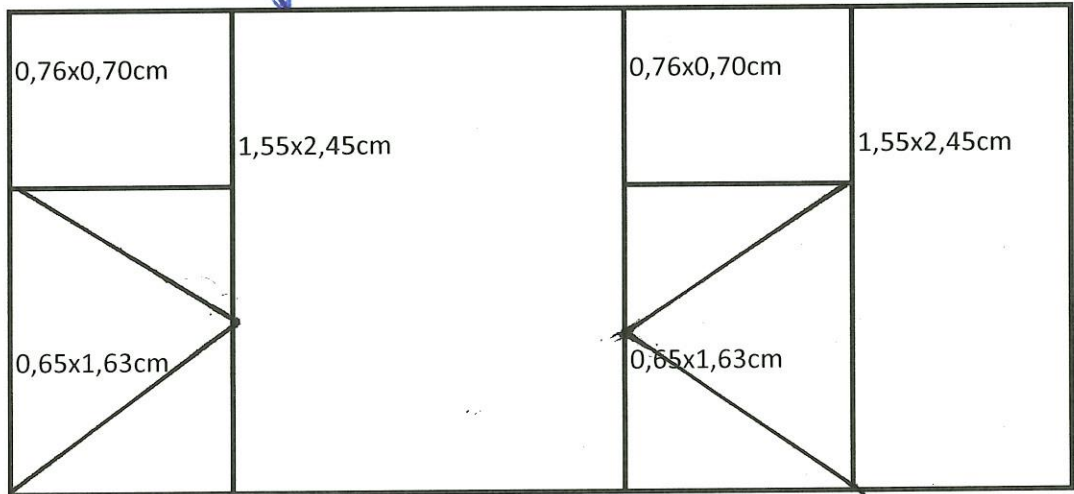

Suprafata estimata 14,61 mp

Dimensiuni orientative

Sala E207



E 207

- 1. $0,65 \times 1,30 \text{ m} = 0,85 \text{ mp}$
- 2. $1,68 \times 1,40 = 2,35 \text{ mp}$
- 3. $0,60 \times 1,70 = 1,02 \text{ mp}$

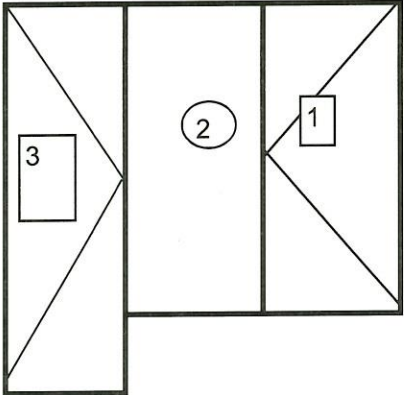

- 1. $0,65 \times 1,30 \text{ m} = 0,85 \text{ mp}$
- 2. $1,68 \times 1,40 = 2,35 \text{ mp}$
- 3. $0,60 \times 1,70 = 1,02 \text{ mp}$

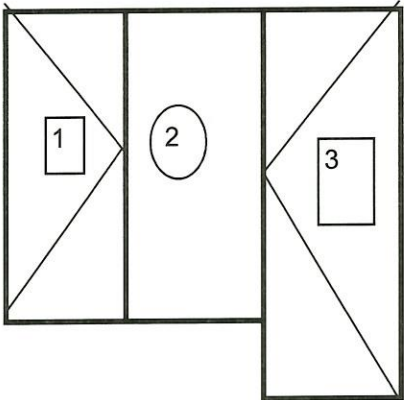

Total = 8,44 mp

Dimensiuni orientative E 122

Pozitia 1 1,31 x 2,15 cm - 1 bucata

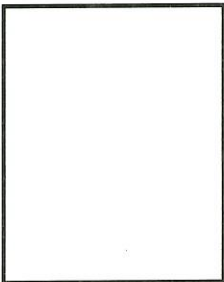

Pozitia 2 - 1,17 x 1,86 cm- 1 bucata

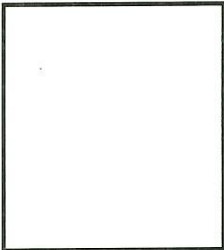

Pozitia 3 0,76 x 0,70 cm- 2 buc.
0,65 x 1,55 cm - 2 buc.
1,44 x 2,35 cm - 1 buc.

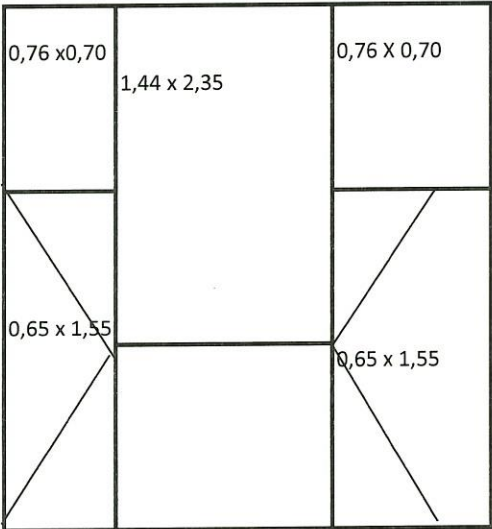

Suprafata estimata - 11,01 mp

Falzele verticale

Dimensiuni orientative E 119



1,57 x 2,97 cm - 1 buc.

1,86 x 2,97 cm - 1 buc.

1,71 x 2,97 cm - 2 buc.

Suprafata estimata - 20,33 mp